

MOUNTING HINGED DOOR

1.1 PREPARATION OF THE WALL COMPARTMENT

The measurements of the opening must be accurate within 5 mm tolerance, so that the construction of the door fits the opening.

Prepare wall doorway dimensions suitable to the door model.

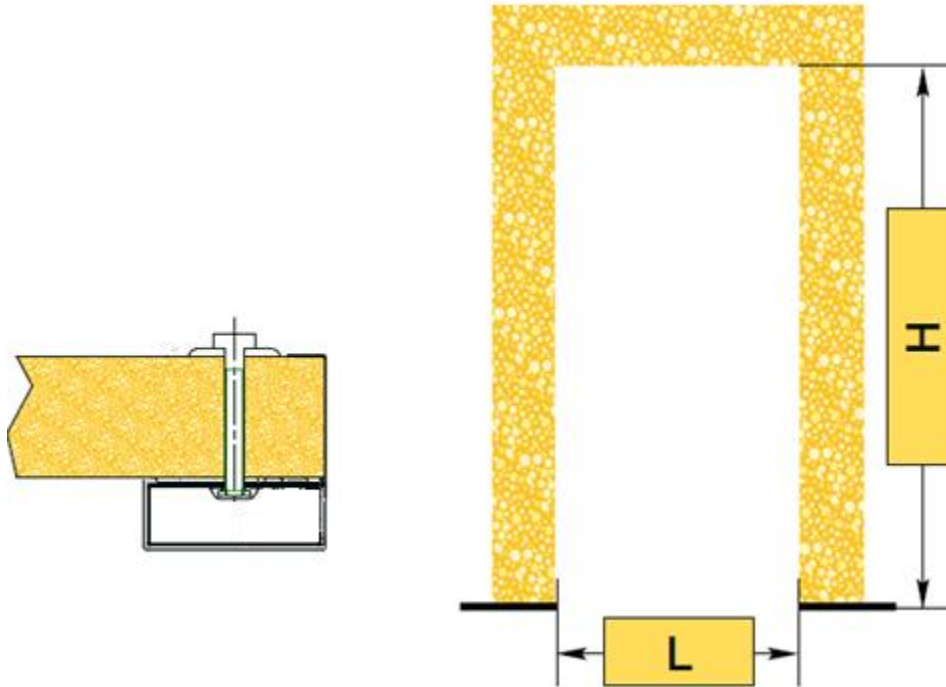

1.2 PREPARATION OF THE FLOOR

1. If the floor does not exist yet, it is essential to know the finished floor level for fixed the frame at the correct height.
2. If the door has a threshold, before installing the frame it is necessary to check that the hole in the wall also continues under the floor in order to lay the threshold. The threshold must be positioned at ground level and successively bricked-up. (See picture below)

MOUNTING HINGED DOOR

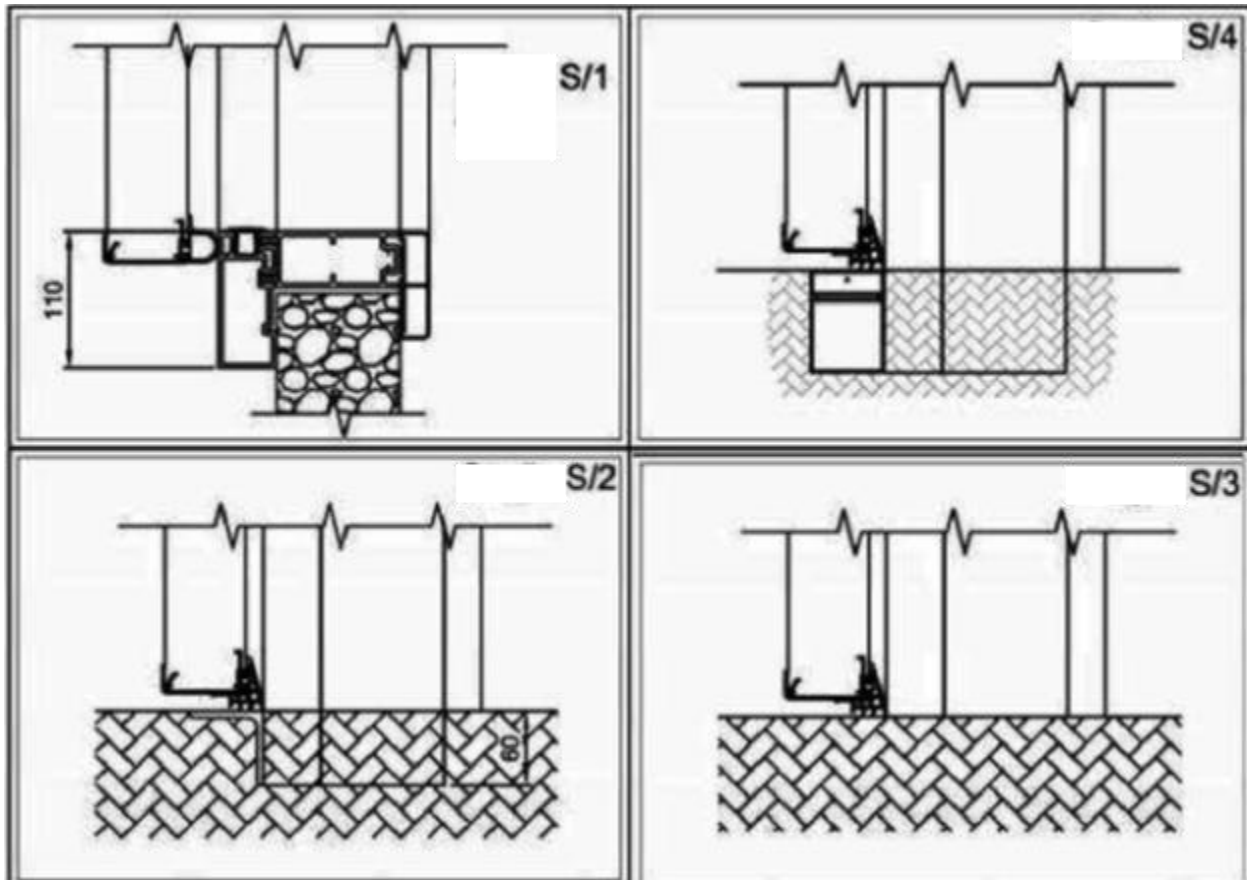

1.3 PRELIMINARY OPERATIONS TO BE CARRIED OUT BEFORE INSTALLATION

Check the door package for damage, if you found any damage please contact manager.

As the supplied door is already assembled, please check package for fasteners. Quantity shown down below.

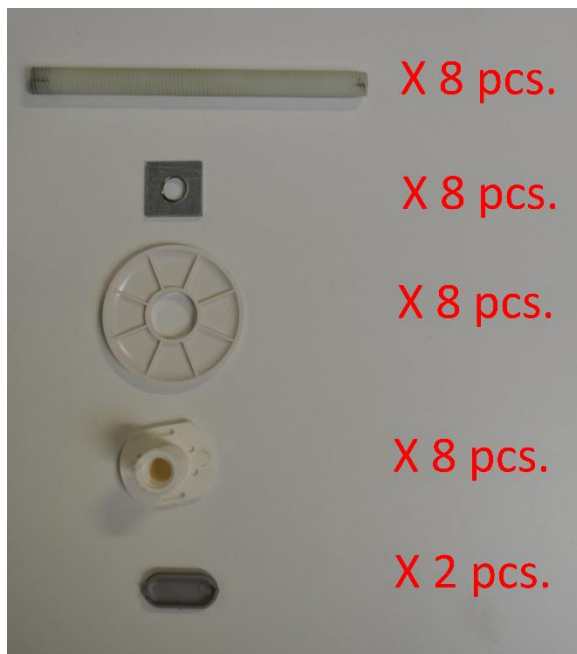

MOUNTING HINGED DOOR

1.4 MOUNTING THE DOOR

Doors are assembled together with a doorframe, so first you have to separate door blade from doorframe. Remove hinge protection ring (picture 1) and separate door blade from the doorframe (picture 2).



Picture 1



Picture 2

Take the plastic rod and the metallic nut from fasteners box and tie up like shown on the picture 3



Picture 3

MOUNTING HINGED DOOR

Insert the rod in the doorframe like shown in the picture 4 and 5.



Picture 4 and 5

On the top of the door frame there is special cut hole to insert rod.

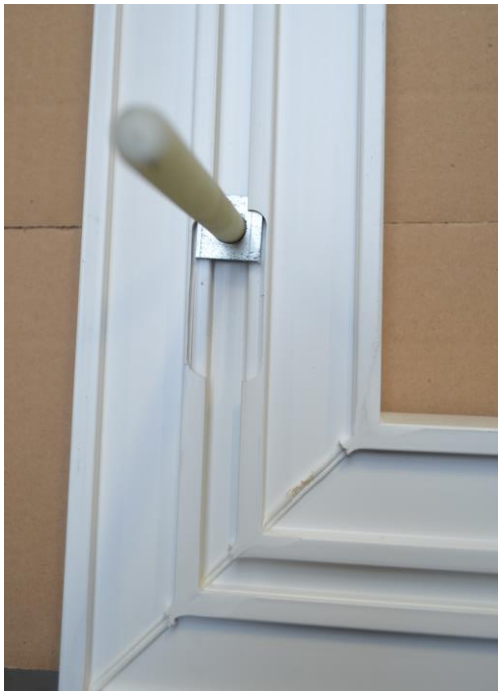

Picture 6

MOUNTING HINGED DOOR

Prepare holes in the wall on the same place as rods inserted in frame.

Fix the frame to the wall using the existing holes, introducing fasteners (picture 7) and lightly tighten the same.

Check the flatness of the frame using a spirit level air. If the frame not be on level, apply spacer until it is perfectly level and coplanar. This is the condition for the good functioning of the door.

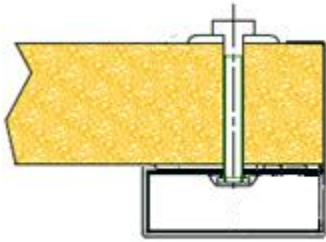

Picture 7

Place the door blade back on doorframe and insert protection ring. Remove hinge protection plate and adjust doors position with the screws (picture 8).



Picture 8

MOUNTING HINGED DOOR

Adjust handle striker plate that door gasket seal the doors to the frame correctly, also put covers on it.



Picture 9 and 10

The door now is installed.

Make a good cleaning (including removing the protective film from surface door) and applied the silicone to the external edges.

Make a check on the correct gasket crushing, which may regulate the striker for handle.

MOUNTING HINGED DOOR

Maintenance on door parts

Maintenance on door parts should be performed as specified in the table shown below:

Door part	Time frame	Maintenance
Lubrication	Every 6 months	The frequency of lubrication is governed by the environmental conditions at the location of the door. The self-lubricating bushings, in normal service, need not be lubricated. However, it is recommended that a few drops of light oil periodically be used on all moving parts.
Door gaskets and inner edge of door	Every 3 months	Clean gaskets to allow for smooth contact between door and gaskets. (Soap and water is recommended for cleaning)
Latches, strikes, fasteners (includes all hardware)	Every 3 months	Check and re-tighten as required.
Sealant	Every 3 months	During the life of the door it is possible for the factory sealant in the seams and joints to come loose, either from abuse or normal use. It is critical that all seams and joints are kept vapor tight at all times. Inspect seams and joints (of door, window, and frame) for loose or missing sealant. Approved sealant must be applied if replacement is necessary. Failure to do so will affect watertight integrity and cause deterioration of the door. Failure to maintain sealant will void the warranty.

MOUNTING HINGED DOOR
